

The Fulbright Partnership  
LANDSCAPE ARCHITECTS

Member of the American Society of Landscape Architects  
1160 Moody Bridge Road • Cleveland, SC 29635 • 864-836-6800

This drawing and the associated MicroStation files are an instrument of service and the property of The Fulbright Partnership and shall not be used or reproduced in any way without the written authorization from The Fulbright Partnership.

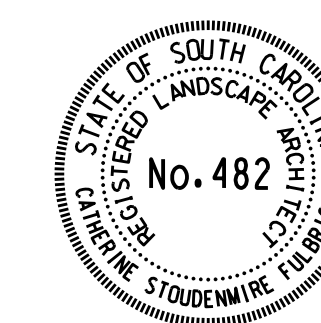

**PLAN NOTES:**

1. REMOVE ALL EXISTING BRICK WALLS AND FOOTINGS.
2. REMOVE ALL CONCRETE PAVING AND STEPS WITHIN WORK LIMITS.
3. REMOVE ALL TREES, SHRUBS AND GROUNDCOVER WITHIN WORK LIMITS.
4. REMOVE WROUGHT IRON RAILING AND FOR POSSIBLE REUSE BEHIND LIFE CENTER.
5. REMOVE THE TOP 18" OF SOIL WHICH CONTAINS ASHES IN MEMORIAL GARDEN (HATCHED AREA) AND STORED ACCORDING TO RECTOR'S DIRECTION.
6. REMOVE BRICK PAVERS IN MEMORIAL GARDEN AND STORE TO THE REAR OF LIFE CENTER.
7. REMOVE FLAT ROCKS AT SANCTUARY ACCESS AND STORE BEHIND LIFE CENTER.
8. TRANSPLANT PERENNIALS FROM SITE TO A HOLDING AREA DETERMINED BY GARDEN COMMITTEE.
9. EXISTING CATCH BASINS AND DRAINAGE LINES NEED TO REMAIN OPERATIVE DURING DEMOLITION AND CONSTRUCTION.
10. CAREFULLY REMOVE EXISTING WROUGHT IRON GATE AND FENCE AND STORE IN DESIGNATED AREA BY OWNER. WILL BE RE-INSTALLED AND INCORPORATED WITH NEW WROUGHT IRON FENCING.
11. CAREFULLY REMOVE EXISTING SEAT WALLS AT MAIN ENTRANCE. THEY ARE TIED INTO BUILDING WING WALLS.

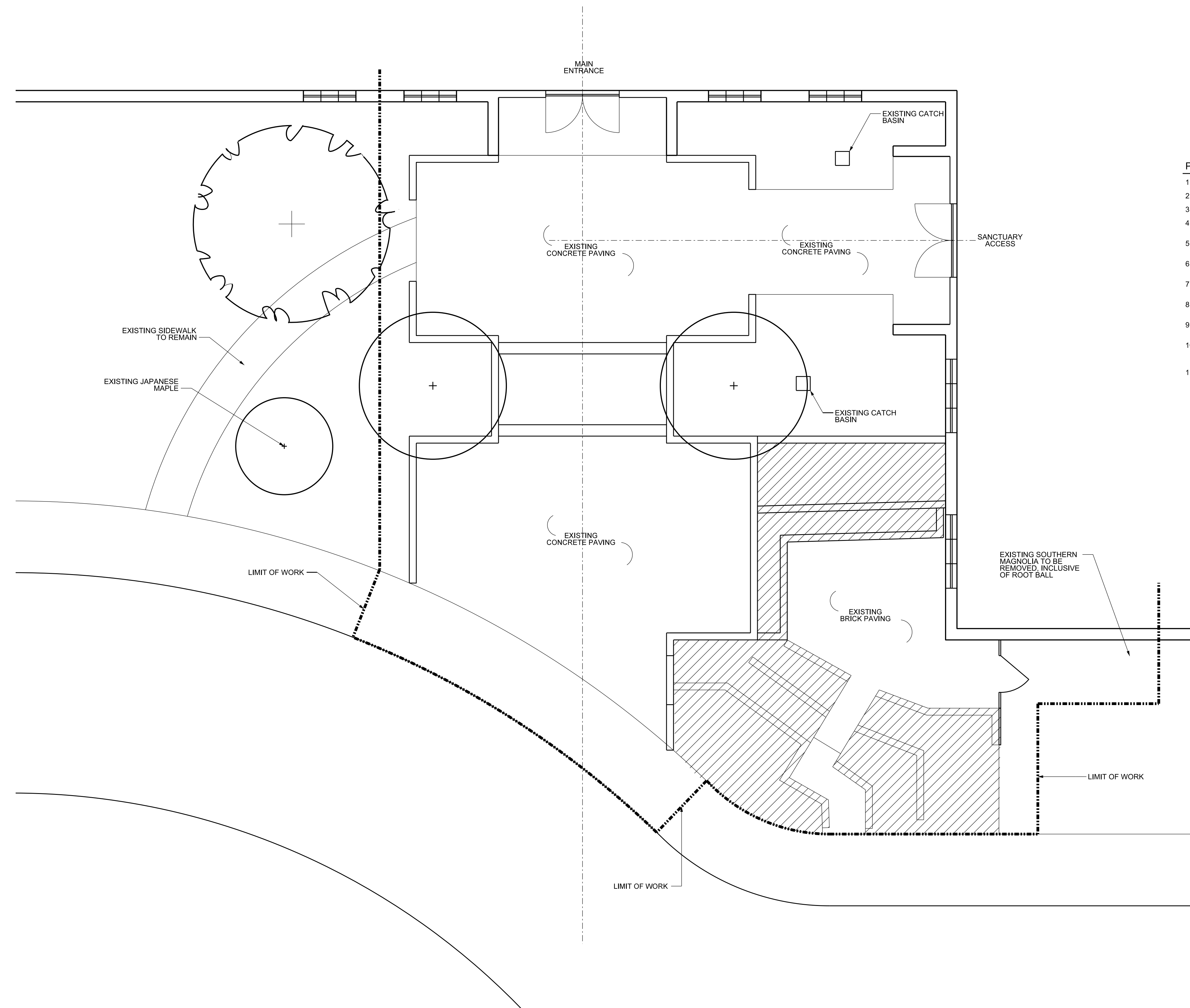

**DEMOLITION PLAN**

ST. JAMES  
EPISCOPAL CHURCH  
GREENVILLE  
SOUTH CAROLINA

Drawn By: CSF  
Scale: AS SHOWN  
Date: 7 NOV 16

Revision:  
ISSUED FOR BID  
ADENDUM 1 - 5 DEC 16  
ISSUED FOR CONSTRUCTION  
- 4 JAN 17

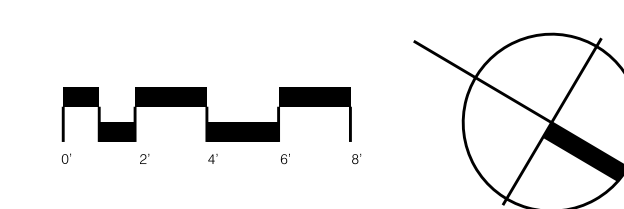

Sheet:  
**L1** OF **4**